



Post bases

11013.1100

Innovative wood connection systems for highest requirements.



Post bases Threaded rods

PTP easy post base 11013.1100

Designed for compressive, tensile and transverse forces



Upper plate mm	100 x 100 x 6
Lower plate mm	160 x 100 x 6
Thread M24 mm	150
Borehole Ø 13 mm bottom	4
Borehole Ø 12 mm top	4
max. characteristic pressure bearing capacity (kN) *	100,0
CE	*

* For further static values see design manual or ETA 10/0413

Assembly instructions 11013.1100

Assembly instructions:

- The post base is fastened to the cross-grained wood with fully threaded plate screws, 10 x 120 mm.
- The lift-off value can be increased by increasing the effective thread length. Please refer to our design manual for the formula.
- Fasten to foundation with tie bolts, Multi Monti etc. (must be verified separately).



Pitzl Metallbau GmbH & Co.KG
Siemensstraße 26
D - 84051 Altheim

Phone: +49 8703 9346-0
Fax: +49 8703 9346-55
E-mail: info@pitzl-connectors.com

Product information and
terms and conditions at
www.pitzl-connectors.com

Post bases Threaded rods

PTP easy post base 11013.1100

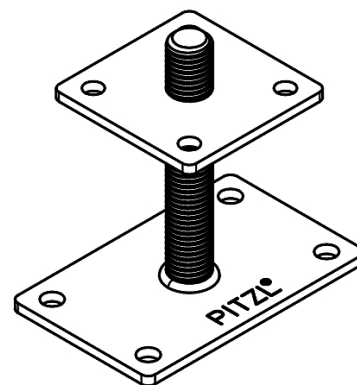
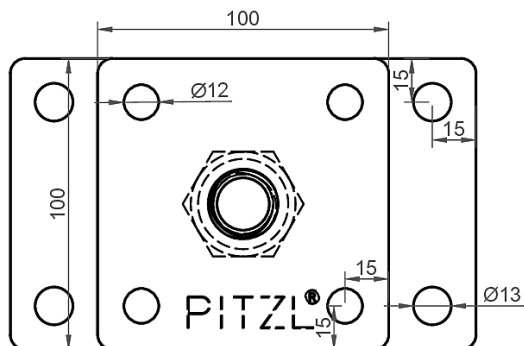
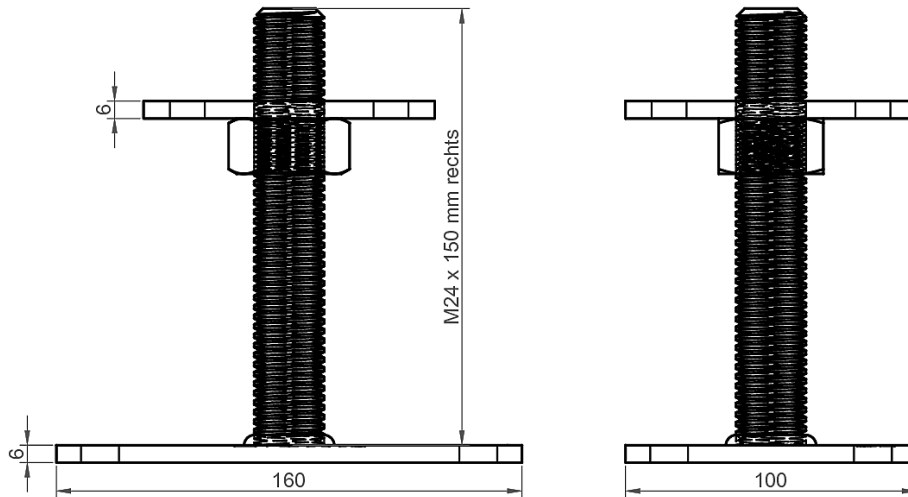

Pitzl Metallbau GmbH & Co.KG
Siemensstraße 26
D - 84051 Altheim

Phone: +49 8703 9346-0
Fax: +49 8703 9346-55
E-mail: info@pitzl-connectors.com

Product information and
terms and conditions at
www.pitzl-connectors.com

Post bases Threaded rods

PTP easy post base 11013.1100

Static values

Direction of force	Char. load-carrying capacity (kN)	Design value γ_M 1,3 and k_{mod} (kN)				
		Permanent 0,6	Long 0,7	Medium 0,8	Short 0,9	Instantaneous 1,1
F ₁ Compression	100,00	46,15	53,85	61,54	69,23	84,62
F ₁ Tension Nut, welded	7,40	7,40**				
F ₁ Tension Tension plate	3,60	3,60**				
Lateral force F ₂ /F ₃	2,80	2,80**				
Lateral force F ₄ /F ₅	1,70	1,70**				

Further static values can be found in our design manual at www.pitzl-connectors.com/en/downloads

Accessories

Item no.	Description
99210.1012	Washer-head screw 10 x 120 mm
50020.2400	Drill jig for precise guidance of the drill bit Ø 24 mm



Pitzl Metallbau GmbH & Co.KG
Siemensstraße 26
D - 84051 Altheim

Phone: +49 8703 9346-0
Fax: +49 8703 9346-55
E-mail: info@pitzl-connectors.com

Product information and
terms and conditions at
www.pitzl-connectors.com